

NORTH WEST SECTION

NICHES
 owner: Abby Korstwijk
 Ashes - I: 2-27-2004

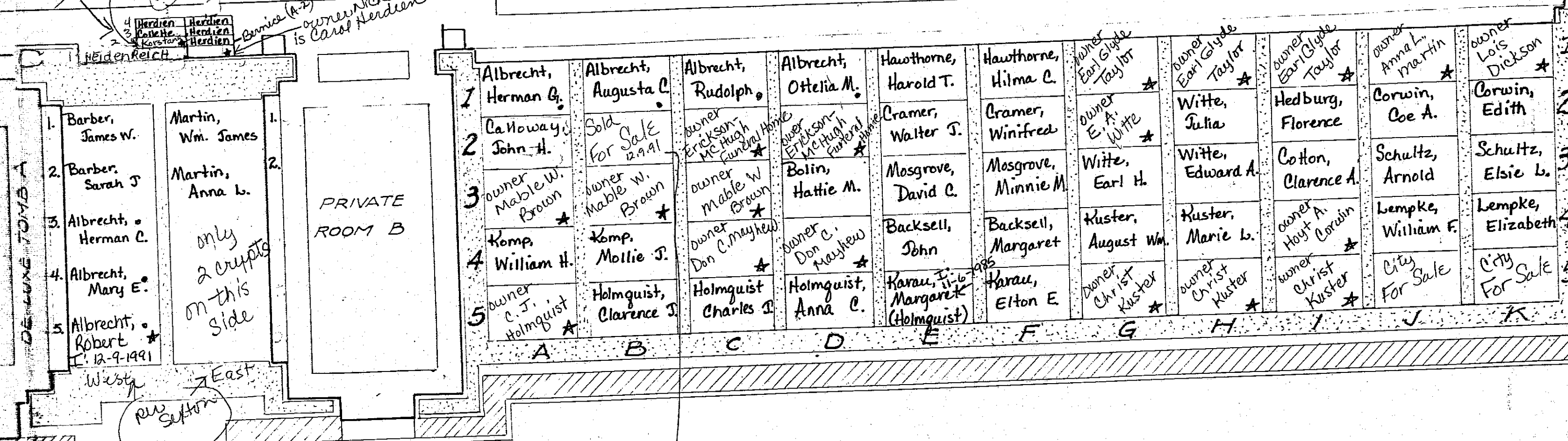

only 2 crypts on this side

City may still own this?

MEMORIAL
CO.

SOUTH WEST CENTER SECTION

for Burials
in Private
Room H

PRIVATE ROOM H For Sale SPS	1	Warner, Perley D.	Warner, Mayme E. I: 8-10-1984	Warner, Fred B.	Warner, Hattie	Warner, Ethel	owner Paul Beuster *	owner Paul Beuster *	owner John Blair *	Blair, John L.	Blair, Frances E.	owner F.W. Fuerst *	owner F.W. Fuerst *
	2	Townsend, Aaron G.	Townsend, Laura E.	Townsend, Cora Mae	Anderson, Louise C.	Anderson, Ernest W.	Zang, Edward C.	Fuerst, Albert A.	Fuerst, Antoine	Gutschlag, August F.	Gutschlag, Caroline	Gutschlag, Elda	Gutschlag, Leon C.
	3	West, John C.	West, Mabel	Weinrich, Herman C.	Palmer, Cora (Weinrich)	Zang, Joseph H.	Zang, Joseph H.	owner George Barton *	owner George Barton *	Charlet, William	Charlet, Ottie C.	owner Charlet Wm. Jr. *	owner Charlet Wm. Jr. *
	4	City For Sale	Anderson, Samuel E.	Anderson, Betsy	Faul, William	Faul, Ethel M.	Vivian Helmers (Ashes) I: 6-30-1989	Nelson, Corliss A.	Nelson, Maude M.	Minks, Henry F.	Minks, Carrie C.	Fleer, Gottlieb	Fleer, Sophie
	5	Pickett, Maxine	Pickett, Velaska	Seely, Rose ?	Seely, Elbert ?	Seely, Leland	Wilson, Myron C.	Wedding, Frances I. (Wilson)	City For Sale	owner Lora E. Nelson Elliott Died 1-2-1957	Nelson, Arthur F.	Anderson Josephine Lindstrom I: 3-26-1999 (Ashes)	Lindstrom, Ruebin
PRIVATE ROOM G For Sale SPS	1	Keim, Kate	Keim, Fred L.	Wells, Lessie	Wells, Connell J.	Peterson, Ida	Peterson, Victor P.	Twist, Benny P.	Twist, Walter	Grice, Sarah	Grice, John T.	Grice, Mary Ellen	Grice, Albert
	2	Mayhew, Effie L.	Mayhew, Jacob Y.	Mather, Emma	Mather, Archibald	owner Maude T. Raleigh *	owner Maude T. Raleigh *	Hoppes, Lelia M.	Hoppes, Samuel C.	Hawthorne	Hawthorne	Hawthorne, Lucy ?	Hawthorne, Robert
	3	Taylor, Mary A.	Taylor, Albert C.	Henry, Scott ?	Henry, States L. ?	Frank, Clara May	Ranstrom, George W.	Ponto, Carrie	Ponto, Edward	Tracy, Lena M.	Tracy, James	Martin, Sarah C.	Martin, David M.
	4	Sharp, Ella	Sharp, Samuel J.	Hewitt, Sarah	Hewitt, Wm. H.	Elmquist, Mary	Elmquist, Carl	owner Albert Bergland *	owner Albert Bergland *	Booth, Norris R.	Booth, Jennie	Booth, Robert R.	Kearns, Mary ?
	5	Warner, Margaret	Warner, Samuel C.	Aten, Florence E.	Aten, Fred S.	Ingle, Mayme E.	Ingle, Clyde F.	Johnson, Carl A.	Johnson, Hanna R.	Wever, Lizzie	Wever, Charles	Gafvert, Emma	Gafvert, Fritz

for Burials
in Private
Room G.

NORTH WEST CENTER SECTION

WEST SIDE

5 (F) Clears, Helen (Ashes)
I: 12-29-1989

5 (F) Siddall, Esther L.
I: 12-29-1989
(Ashes)

5	Clears, Mary I: 12-29-1989	5 (F) Siddall, Fred (Ashes) I: 12-29-1989
4	Loomis, Esther	
3	Clears, Harry Loomis	
2	Clears, Harry R.	
1	Clears, Sarah F.	

PRIVATE ROOM I
10 Sps.
All owned by
Thelma Jean Davis

	A	B	C	D	E								
5	Anderson, Annie	Anderson, Jess	Hotchkiss, Lucia G.	City For Sale	City For Sale	City For Sale	City For Sale	City For Sale	City For Sale	City For Sale	City For Sale	City For Sale	City For Sale
4	City For Sale	City For Sale	Empson, Luella	Empson, W. J.	Anderson, Nellie	Anderson, Nels	Johnson, Carl H.	Griese, Fred A.	Sundberg, Helen H.	Sundberg, Joseph M.	owner Thelma Davis	owner Thelma Davis	owner Thelma Davis
3	Nelson, Andrew P.	Nelson, Matilda	Nelson, Edwin C.	Ripka, Anna M.	Ripka, John W.	Schultz, Clara E.	Schultz, Anna M.	Schultz, August A.	Klein, Minnie W.	Klein, Karl J.	owner Thelma Davis	owner Thelma Davis	owner Thelma Davis
2	Timson, Alice	Timson, John	Doye, Minnie	Doye, Charles	owner Ellen Byers *	owner Ellen Byers *	Byers, William M. I: 11-29-1988	Byers, Ellen	Couve, Mary E.	Couve, William	White, Ted	White, Ted	White, Ted
1	Lindstrom, Lillian	Lindstrom, Henry	Duncan, Emma	Combs, Sarepta	Combs, Horace J.	Naseef, George W.	owner W.F. Couve *	owner W.F. Couve *	Sepp, Augusta William	Charlet, Sophia Elenora Mary	Charlet, August	Charlet, August	Charlet, August

SOUTH WEST SECTION

NORTH EAST SECTION

J. V. Turns around (west)

Archer, John	Archer, George Charlotte Sara	Archer, Grace	Manthe Ernest C.	Manthe, Adelia	owner Ernest Manthe *	owner William Statz *	owner William Statz *	Statz, William	Statz, Emma L.	Statz, William H.
Myers, Olesa H.	Myers, Mary E.	Walton, Joseph C.	Walton, Ruby	Hallin, Forrest L.	Hallin, Julia E.	Hallin, Anna Andrew Elvira R. Walter F.	Dexter Gladys	Dexter, Grace	Dexter, George G.	Dexter, Emma F.
Walker, Richard	Walker, Elizabeth	Boggs, Dow John	Boggs, Ella C.	Wilke, Carl H.	Wilke, I: Go. Cora 4-17-1884 \$125.00 C+S	Hallin, Jennie	Bartz, William F.	Bartz, Hulda	Bjurstrom, Carl T.	Bjurstrom, Edith
Weston, Stutely	Weston, Rose	Kuster, Carl A.E.	Kuster, Nellie E.	Wester, Warren	owner Thelma J. Davis *	owner Samuel J. Buchanan *	owner Samuel J. Buchanan *	owner Samuel J. Buchanan *	Buchanan, Samuel J.	Buchanan, Leonora.
Jones, William T.	Jones, Lydia M.	McNeely, Myrtle S (Jones)	Seely, William Electra	owner Gert Thompson *	owner James R. May *	owner Dr. N. Klein *	Klein, Esther	Burgland, Nellie J.	Burgland, John.	
K	J	I	H	G	F	E	D	C	B	A

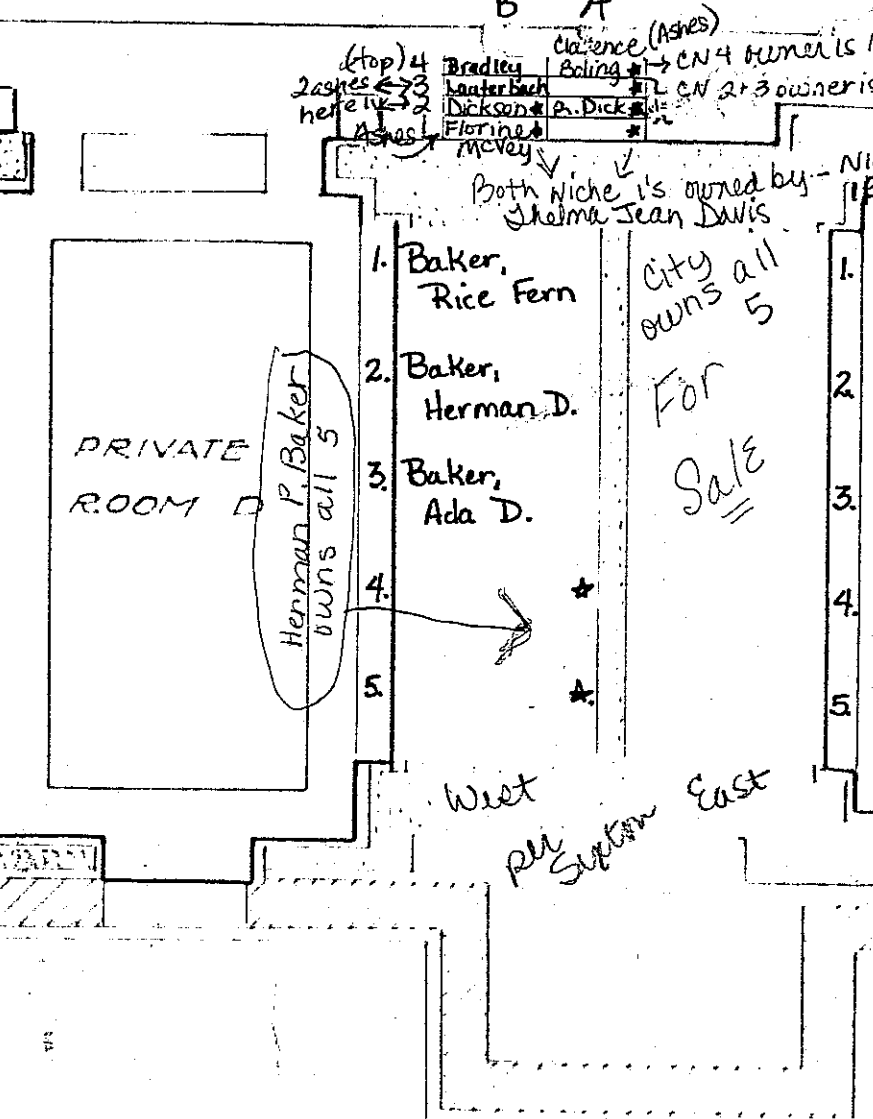

(top) 4 Bradley
2 ashes ← 3
help → 2
Ashes
Clarence (ashes)
Boling → CN 4 Turner is M
Dickson → CN 2 + 3 owners
Florence
Mcvey

Both Niche's owned by - Nic
Shelma Jean Davis

or burial of Harry L. Clears

SOUTH EAST CENTER SECTION

these spaces
for burials in
Private Room F.

1	City For Sale	Fuller, Baxter	Fuller, Mary A.	Fuller, Arthur B.	Broughton, Charles C.	Broughton, P. Mae	City For Sale	Vandenberg, Martha	Vandenberg, Bernard	Vandenberg, Nathalie	Brynildson, Anna E.	Brynildson, Anton		
2	Pearce, James I.	Pearce, Ella T.	Florence White Wife of George White	Fred Niley I: 8-20-1992 Man the infant I: 9-11-1938	owner Ernest Duston *	owner Ernest Dustin *	Peterson, Oscar D.	Peterson, Raphael D. Jennie	Anderson, Joseph W.	Anderson, Blanche	Neubert, Wilhelm	Neubert, Ernestine	owner Thelma	PRIVATE ROOM F
3	Grow, Earl W.	Grow, Emma E.	Trask, Harry W.	Trask, Agnes S.	Woods, Roscoe G.	Woods, Mae V.	Peterson, Pearl E. I: 7-2-1985	Kaiser, Alvin Elaine } Ashes	Marlow, Henry L.	Marlow, Almeda	Schueneman, Herman C.	Schueneman, Rosalie	Thelma Jean	PRIVATE ROOM F
4	Boyle, Andrew T.	Boyle, Mary L.	Catherine Roddy I: 1-17-1997 *	Roddy, Dr. Robert	Cross, Henry C.	Cross, Glona B.	May, John C.	May, Della L.	owner Thelma Davis *	owner William Berg *	Hadjis, Peter S.	Bessie Hadjis I: 6-5-1991 *	DAVIS	PRIVATE ROOM F
5	Jacobs, Mabel C.	Lowe, Francis O.	Lowe, Lena	City For Sale	City For Sale	City For Sale	Forsthove, Joseph G.	Forsthove, Alice	Martin, Wallace A.	Martin, Mae	owner B. H. Broughman *	owner B. H. Broughman *	5	PRIVATE ROOM F
	M	L	K	J	I	H	G	F	E	D	C	B	A	
5	Kueter, Lottie	Kueter, Waldemar	Kueter, Emma	owner Thelma Jean Davis *	Green, Fred Elizabeth?	Green, John Alvan J Lewis G Elizabeth	owner John R. Green *	owner John R. Green *	Winans, Faye	owner Thelma Jean Davis *	owner Thelma Jean Davis *	owner Thelma Jean Davis *	owner	PRIVATE ROOM E
4	White, Clifford H.	Stone, Mary	Stone, Fred Jr.	Doy, Mary Stone	Doy, Fred F.	owner S. L. Anderson *	Anderson, Ingeborg R.	Anderson, John L.	Shilton, Adela	Shilton, Christopher	owner Thelma Jean Davis *	owner Thelma Jean Davis *	Thelma	PRIVATE ROOM E
3	owner John R. Green *	owner John R. Green *	Blair, Evelyn L.	Blair, Amos L.	City For Sale	Larson, Eda E.	Dickson, Ellen K	City For Sale	owner Keweenaw Lumber & Supply (Taylor) *	owner Keweenaw Lumber & Supply (Taylor) *	owner Keweenaw Lumber & Supply (Sanders) *	owner Keweenaw Lumber & Supply (Sanders) *	Jean	PRIVATE ROOM E
2	Edith Glidden 2-16-1989 *	Glidden, Raymond	Robt. A. Gish D# 2401 5-20-1993	City For Sale	owner Andrew Anderson *	Anderson, Andrew P. here? or owner	Kraig, Caroline H.	Kraig, Benno R.	Hodgett, Ada T.	Hodgett, Samuel	owner C. M. Hamilton *	owner C. M. Hamilton *	Davis	PRIVATE ROOM E
1	Swift, George F.	City For Sale	Neubert Louisa C.	Neubert, Otto P.	Romig, Margaret	Romig, John W.	Martin, Lloyd E.	Martin, Alice	Martin, Edwin A.	Martin, Charles A.	Martin, Mary O.	Martin, Hugh A.	7	PRIVATE ROOM E

NORTH EAST CENTER SECTION

these spaces
for burials in
Private Room E

City For Sale owner Gust E. Larson *	City For Sale Wedge, Frank M.	owner Hiram Murchison *	owner Hiram Murchison *	City For Sale Robb, Samuel E.	City For Sale City For Sale Bolstad, Charlotte	Roberts, Dean Ellis	Roberts, Amelia M.	Roberts Roscoe E	owner Roscoe Roberts *	owner Roscoe Roberts *	owner Mrs. E.T. Erickson
owner Gust E. Larson *	Larson, Ida M.	Larson, Gust	Sward, Carrie M.	Sward, Peter P.	Johnson, Frank D. Irene Taylor	Stone, Helene A.	Stone, Frank W.	City For Sale Townsend, Melissa	City For Sale Townsend, Roy A.	4 Donavan	4 Erickson, Ida Ydeen
Boyd, ♂ Fannie R.	Boyd, ♂ Randolph.	Sturm, Minerva I.	Sturm, Chas. D.	Duncan, Ella M.	Duncan, George B.	Dorr, Irene Clore	Dorr, Albert W.	owner Dudley Rule *	owner Dudley Rule *	3 Erickson, Eric Thure	3 Erickson, Eric Thure
Johnstone, Mora Aida	Johnstone, Elizabeth M.	Johnstone, Henry Clay	Johnstone, Earl M.	Johnstone, Helen B.	Johnstone, loyd A.	owner H.P. Baker	owner H.P. Baker *	owner August C. Couve *	owner August C. Couve *	1 Gutschlag, Laura C.	1 Couve, August C. I: 8-22-1991

SOUTH EAST SECTION

PRIVATE ROOM L

1. Craig, Bert
2. Craig, Elizabeth
3. Erickson, Ida Ydeen
4. Donavan
5. Erickson, Mrs. E.T.

City owned
this side of Room L

C O